

BRASS SAFETY VALVE

LEHRY Safety valve is part of the safety device for solar energy systems installations feed with water or water mixture as vector, according to DIN4757part 1. The valve discharge pressure is factory-set and cannot be modified without manumission of the seal, placed on the cap, which indicates setting pressure and approval mark.

Specification :

- ❖ Forged brass body
- ❖ Working pressure:3 & 6 bar
- ❖ Long lasting high temperature resistant diaphragm
- ❖ Manual discharge knob in shockproof resin
- ❖ Max working temperature:120°C
- ❖ Stainless steel spring
- ❖ Seal contact with hot water proof rubber
- ❖ Female thread connections are to ISO228
- ❖ Product conforms to EN1489:2000



Maintenance :

In order to assure a correct functioning, the safety valves must be checked periodically. In an installation, normally, the safety valve remains closed. During the time, impurities may settle near the shutter, it is necessary to proceed with a periodical washing of the valve seat, turning the knob in the direction shown by the arrow on the disk. Almost the total of problems (droppings, uncompleted closings) are caused from the presence of dirt between valve seat and shutter, periodical washings and verifications will prevent problems.

Technical Features :-

	3 Bar	6 Bar
Inlet Connection	: 1/2" female DIN-ISO228/1	
Outlet Connection	: 3/4" female DIN-ISO228/1	
Set Pressure (Bar)	3	6
Discharge Pressure (Bar)	3.25	6.6
Closing Pressure (Bar)	2.5	4.8
Discharge flow (l/h) (measured with cold water, at discharge pressure +10%)	3000	5400

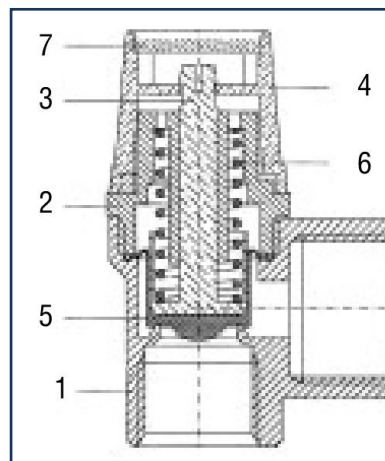
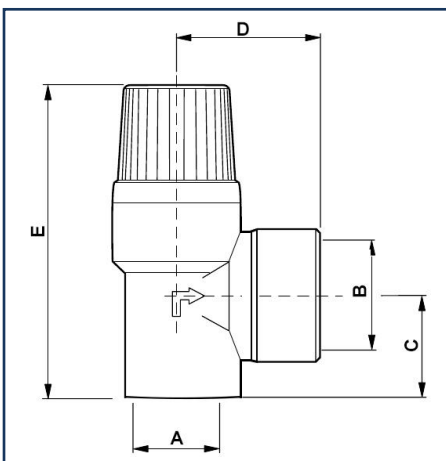

Technical Details

- 1) Body
- 2) Cage
- 3) Stem
- 4) Knob
- 5) Diaphragm
- 6) Spring
- 7) Disc

Dimensions :-

(All Dimensions are in mm)

SIZE	A	B	C	D	E	Pressure
1/2" X 3/4"	1/2"	3/4"	31	40	71	3 Bar
1/2" X 3/4"	1/2"	3/4"	31	40	71	6 Bar

Lehry Instrumentation & Valves Pvt. Ltd.,

"Lehry Chambers" #78 (Old No: 51)Sembudoss Street,
P.B No.1506, Parrys, Chennai - 600 001.
Phone : 044 25226995/25225185/25226187/42163823/
42625620/42625621. Fax : 044 25231715
Email : info@lehry.com / Website : www.lehryvalves.com
Branches : Chennai, Bangalore, Hyderabad, Mumbai, Noida, Pune